



# Installation Guide

Perma "R" Products offers these installation instructions to address potential moisture issues, minimize call-backs for repairs, and improve the overall quality of a project. Compliance with the building code and proper installation of all building components that comprise the entire wall envelope are important for the performance of the system to prevent bulk water penetration. Failure to follow these installation instructions could compromise the wall assemblies ability to effectively resist exterior water penetration. For any assistance, contact a local Perma "R" Products representative. For a contact information call 800-647-6130.

## 1. PermaTak™ Straight or Stretchable Sill Flashing

Prepare sill flashing by cutting PermaTak™ at least 12" longer than the width of the rough opening. Install sill flashing by removing the release paper, centering sill flashing on sill framing stud, and adhering into rough opening. The back edge of PermaTak™ should extend to inside edge of sill framing stud and at least 6" up each jamb framing stud. (Note: Sill flashing should not wrap onto the inside of wall). *DO NOT STRETCH MATERIAL ALONG THE SILL OR JAMB.* When housewrap or conventional building paper is used as a weather resistive barrier over the wall sheathing prior to the window and flashing installation, PermaTak™ should be applied over the weather resistive barrier after it has been properly cut and folded in and around the window rough opening.

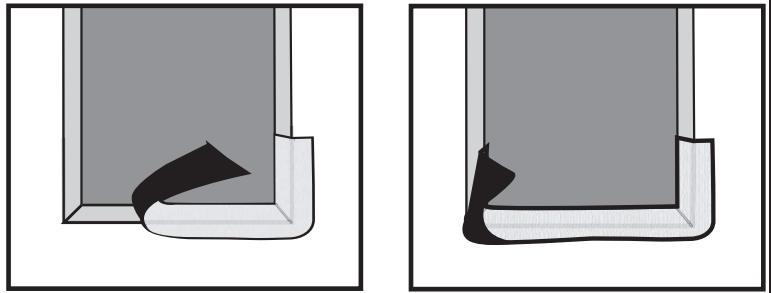

### Note:

If a weather resistive barrier is to be applied after the window and flashing have already been installed, be sure not to fasten the lower edge of the flashing, so the weather resistive barrier may be slipped underneath the flashing in shingle lap (top layer overlapping bottom layer) fashion.

## 2. Window Installation

Before installing the window; (a) apply a continuous bead of sealant to the backside (interior) of the mounting flange near the outer edge. Or, (b) apply a continuous seal to the rough window opening at a point to assure contact with the backside (interior) of the mounting flange. (Do not caulk along bottom). Install window according to manufacturer's installation procedures. Use of a Perma "R" approved caulking is recommended.

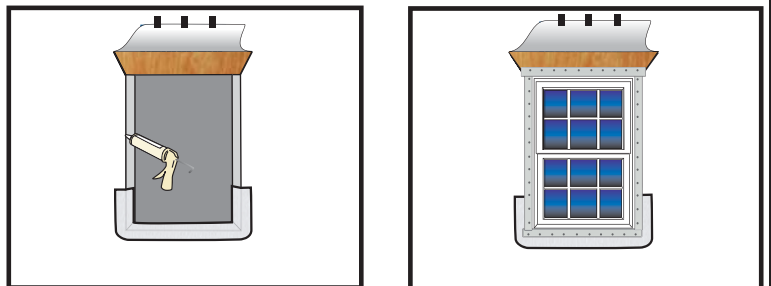

# Installation

## Guide

## Continued

### 3. Side Jamb Flashing

Utilizing a roller to provide firm, consistent pressure, apply PermaTak™ Straight window flashing along vertical sides of the opening. Flash over the side window flanges. Extend the flashing a minimum of 3" beyond the sill flashing already in place and extend the flashing minimum of 3" beyond the top of the opening, so that it projects beyond the head flashing to be applied later.

### 4. Head Flashing

Affix the bottom of the head flashing over the mounting flange. Be sure to extend the flashing beyond each jamb flashing. Secure in place by applying pressure. Unattach housewrap and apply over head flashing as shown. Tape all seams and joints.

### Circular Windows

Follow above instructions for proper installation prior to head flashing installation. Install circular-top windows according to window manufacturers installation guidelines, then follow instructions below to complete the process.

Measure the circular portion of the window and add 12" to this number. Cut PermaTak™ Stretchable or Straight Flashing to this length for the head flashing. Remove approximately 20" of release paper and position PermaTak™ tightly along the first edge of round window, press firmly into place. Continue re-moving release paper and form PermaTak™ along entire circular portion of window. Use seam tape (ContractorPro recommended) or mechanical fasteners (i.e. nails, staples, or screws) to temporarily hold top edge of head flashing to wall. The adhesive bond of PermaTak™ will strengthen over time. Both ends of head flashing should overlap jamb flashings by at least 6".

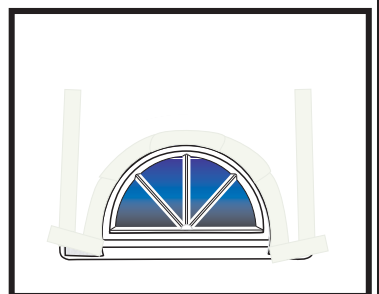
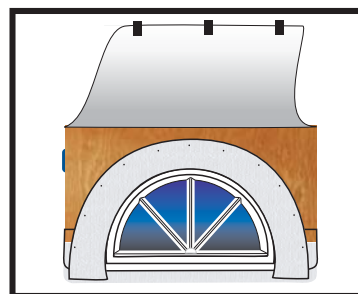
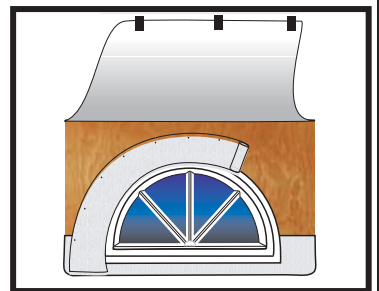
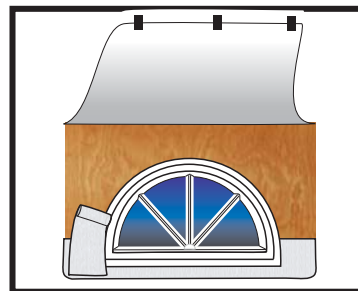
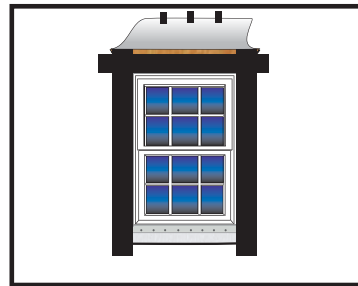
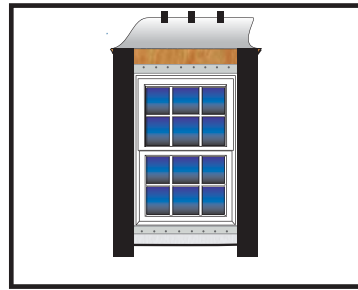

P.O Box 279  
Grenada, MS 38902  
800-647-6130  
[www.permarproducts.com](http://www.permarproducts.com)